

Nuts for Aluminum Extrusions - Overview

For 8 Series (Slot Width 10mm)

Note that, for some of the types shown here, order might be unable to be received by the MISUMI Malaysia, Indonesia and/or India offices.

Nuts for Aluminum Extrusions - Bulk Packages

For 8 Series (Slot Width 10mm)

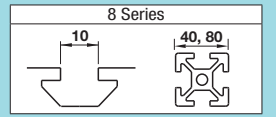

Nuts for Aluminum Extrusions - Overview

MISUMI offers variety of Pre-Assembly or Post-Assembly Insertion Nuts for Aluminum Extrusions. Select an applicable type specific to your application.

Pre-Assembly Insertion: Insert from the slot ends before assembly. Large width causes less plays in the slots, making screw tightening easy.

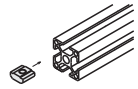

Post-Assembly Insertion: Mountable from slots after assembly.

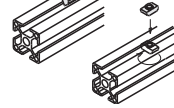

Type	Photo	Features	Pre-Assembly				Post-Assembly			
			Material		Page		Material		Page	
			Steel	Stainless Steel	Single Item	Package	Steel	Stainless Steel	Single Item	Package
Standard		Most standard and economical products. Can be connected temporarily in combination with optional stoppers.	○	○	P669	P668	○	○	P672	P668
Temporary Holding (Ball Spring)		Can be moved in the extrusions smoothly. Temporary holding is repeatedly possible.	○	○	P670	P668	○	○	P673	P668
Temporary Holding (Leaf Spring)		Secure temporary holding with springs on both sides.	-	-	-	-	○	○	P673	P674
Temporary Holding (Resin Stopper)		Resin stopper on outer circumference prevents aluminum extrusions from being scratched when mounting temporarily.	○	○	P670	-	-	-	-	-
Post-Assembly Rotational		Insert the nut into the extrusion and turn it in the slot. Large nut width prevents plays.	-	-	-	-	○	○	P672	-
With Lock		Included set screw enables nut fixing. Convenient where panes and covers are removed frequently.	○	-	P671	-	○	○	P674	-
Thread Locking Adhesive Type		Reduces loosening due to vibrations caused by transfer or equipment moves. One-time use and repeated use types are available.	○	-	P669, 670	-	○	-	P672-674	-
Compact (Short Nuts)		Usable with narrow pitch when multiple nuts are lined in the slots. (Approx. 40% shorter than the standard width)	○	-	P671	P671	○	-	P674	P674
Square Nuts		Sheet metal type: more economical than standard nuts.	○	○	-	P671	-	-	-	-
Screw Integrated		Requires less time for screw tightening.	-	○	P675	-	-	○	P675	-
Long Nut		Workpieces such as Linear Guides are mountable with desired pitches.	○	○	P676	-	○	○	P676	-
Offset Nut (Other than 5 Series)		When connecting the extrusions at corners with Pre-Assembly Insertion Double Joint (refer to P663), the nut does not protrude from the extrusion.	-	○	P671	-	-	-	-	-
Conductive Washers (Other than 5 Series)		Electrical conductivity between extrusions is achieved by combining with Toothed Washer (P675).	-	○	P675	-	-	-	-	-

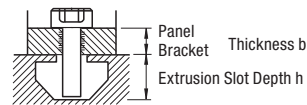

Aluminum Extrusions and Applicable Screws to Mount Panes/Brackets (Size M - L Dim.)

Slot Width	Extrusion Square	Depth h	Applicable Nut HNTT	Panels/Brackets Thickness b (mm) to be mounted on extrusions																		
				0.8	1	1.2	1.5	2	3	4	4.5	5	6	8.2	9	10	12	14				
10	40	12.5	8-4	M4-12																		
			8-5	M5-12																		
			8-6	M6-12																		
			8-8		X																	

*X means there is no applicable screw. Use one size smaller tapped products.

Features: Bulk packages are cost effective for in-house stock or large quantity uses.

Pre-Assembly Insertion Spring Nuts - Pack (100/Pkg.)



Type	M Main Body	M Ball	M Spring	S Surface Treatment
PACK-HNTU	S10C Equivalent	SUS304	SWP-A	Trivalent Chromate
PACK-SHNTU	SUS304 Equivalent (Sintered)	SUS304	SUS304-WP8	-

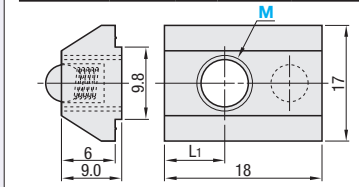

Part Number		M				L1		Unit Price (1 ~ 10 packages)	
Type	No.	4	5	6	8	6	5.5	Package Price	Price per Pkg.
PACK-HNTU	8								
PACK-SHNTU									

100 pcs. per package



Does not fall even if the extrusion is placed vertically. Built-in spring prevents slips. Moves easily in the slot when pressed slightly by hand.

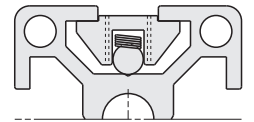

Pre-Assembly Insertion Spring Nuts - Pack (100/Pkg.)



Type	M Material	S Surface Treatment
PACK-HNTT	S10C Equivalent	Trivalent Chromate
PACK-HNTTSN	SUS316 Equivalent (Sintered)	-

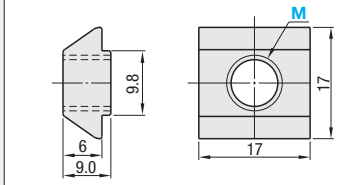

Part Number		M				L1		Unit Price (1 ~ 10 packages)	
Type	No.	4	5	6	8	8	8.5	Package Price	Price per Pkg.
PACK-HNTT	8								
PACK-HNTTSN									

100 pcs. per package

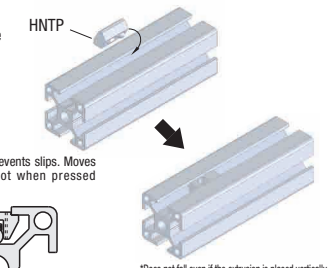

Post-Assembly Insertion Spring Nuts - Pack (100/Pkg.)



Type	M Main Body	M Ball	M Spring	S Surface Treatment
PACK-HNTP	S10C Equivalent	SUS304	SWP-A	Trivalent Chromate
PACK-SHNTP	SUS304 Equivalent (Sintered)	SUS304	SUS304-WP8	-

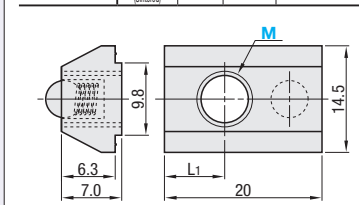

Part Number		M				L1		Unit Price (1 ~ 10 packages)	
Type	No.	4	5	6	8	8	8.5	Package Price	Price per Pkg.
PACK-HNTP	8								
PACK-SHNTP									

100 pcs. per package

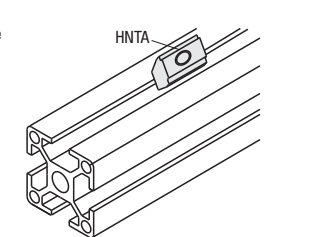

Post-Assembly Insertion Stopper Nuts - Pack (100/Pkg.)



Type	M Material	S Surface Treatment
PACK-HNTA	S10C Equivalent	Trivalent Chromate
PACK-HNTASN	SUS316 Equivalent (Sintered)	-

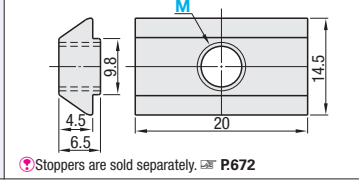

Part Number		M				L1		Unit Price (1 ~ 10 packages)	
Type	No.	4	5	6	8	8	8.5	Package Price	Price per Pkg.
PACK-HNTA	8								
PACK-HNTASN									

100 pcs. per package

Ordering Example: Part Number - M PACK-HNTP8 - 6