

Note that, for some of the types shown here, order might be unable to be received by the MISUMI Thailand, Malaysia, Indonesia, and/or India offices.

# 8-45 Series Aluminum Extrusions 45, 90mm Square

1 Slot

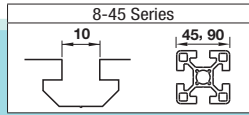

Fixing Parts			Others	
Brackets	Joints	Nut	Extrusion End Caps	Alterations
P.691	P.705	P.713	P.723	P.755
P.704	P.710	P.722		P.768

Features: 1-slot Aluminum 45mm Square Extrusions with a Flat Side



Type		Material	Surface Treatment
Configurable Length	Fixed Length		
GFS_8	KGFS_8	A6061SS-T6 Equivalent	Clear Anodize
NEFS_8	KNEFS_8	A6063S-T5	
EFS_8	KEFS_8	A6N01SS-T5	Black Anodize
HFS_8	KHFS_8		
HFSL_8	KHFSL_8		
HFSB_8	KHFSB_8		

⚠ Cut surface and altered parts are not surface treated.

NEFST8-4545  
EFST8-4545

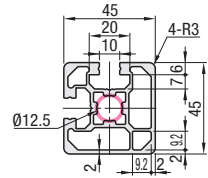

GFST8-4545 (High Rigidity)

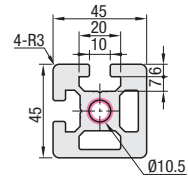

EFSC8-4545

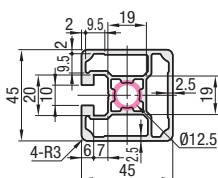

HFST8-4545  
HFSTB8-4545 (Black Anodize)

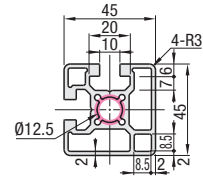

EFSH8-4545

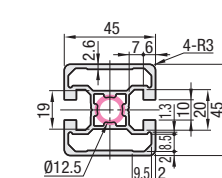

HFSC8-4545

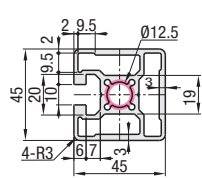

HFSLT8-4545 (Light Type)

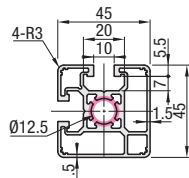

HFSH8-4545

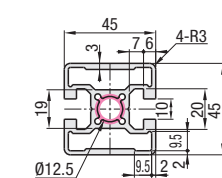

# 8-45 Series Aluminum Extrusions 45, 90mm Square

2 Slots

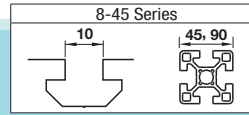

Fixing Parts			Others	
Brackets	Joints	Nut	Extrusion End Caps	Alterations
P.691	P.705	P.713	P.723	P.755
P.704	P.710	P.722		P.768

Features: Extrusions with [1x2 slots]. Effective where forces apply.

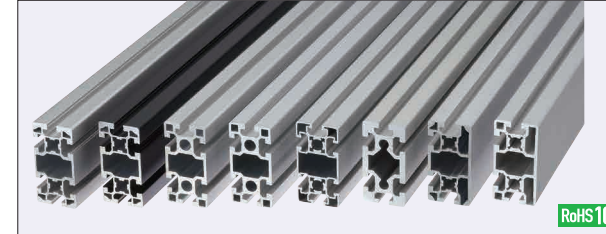

Type		Material	Surface Treatment
Configurable Length	Fixed Length		
GFS8	KGFS8	A6061SS-T6 Equivalent	Clear Anodize
NEFS8	KNEFS8	A6063S-T5	
EFS8	KEFS8	A6N01SS-T5	Black Anodize
HFS8	KHFS8		
HFSL_8	KHFSL_8		
HFSB_8	KHFSB_8		
CAF8	KCAF8		Clear Coating (Anodize + Clear Coating)

⚠ Cut surface and altered parts are not surface treated.

NEFS8-4590  
EFS8-4590  
EFSB8-4590 (Black Anodize)

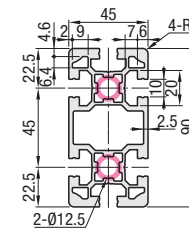

GFS8-4590 (High Rigidity)

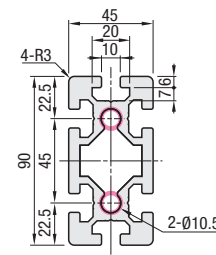

HFS8-4590  
HFSB8-4590 (Black Anodize)

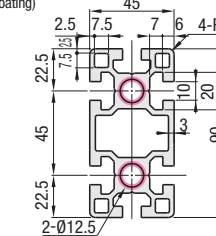

CAF8-4590 (Clear Coating)

EFSF8-4590

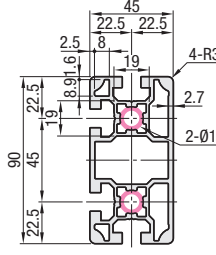

NFSL8-4590  
HFSL8-4590 (Light Type)

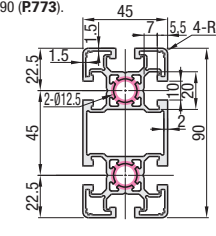

⚠ Use HSCA8 as a slot cover for HFSL8-4590 and NFSL8-4590 (P.773).

HFSF8-4590

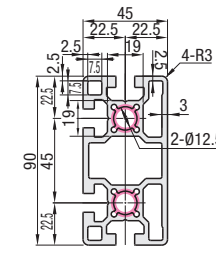

## Configurable Length Extrusions

Part Number	L 0.5mm Increment	Mass kg/m	Sectional Area mm <sup>2</sup>	Cross Sectional Moment of Inertia mm <sup>4</sup>		Unit Price (Less than 300mm)			Unit Price/m (300mm or More)		
				l <sub>x</sub>	l <sub>y</sub>	1 ~ 9 pc(s)	10-49	50-160	1 ~ 9 pc(s)	10-49	50-160
NEFST8	4545 50-4000 Applicable to 6000mm depending on products. Refer to Information of Special Orders (P.103) and contact the person in charge of Special Orders at MISUMI OCT Center. ⚠ Some extrusions are not applicable.	1.80	667	14.67x10 <sup>4</sup>	14.67x10 <sup>4</sup>						
EFST8		1.92	713	14.00x10 <sup>4</sup>	14.00x10 <sup>4</sup>						
HFST8		1.58	585	11.13x10 <sup>4</sup>	11.13x10 <sup>4</sup>						
HFSTB8 (Black Anodize)		3.22	1195	24.46x10 <sup>4</sup>	24.46x10 <sup>4</sup>						
HFSLT8 (Light Type)		1.82	674	14.60x10 <sup>4</sup>	14.86x10 <sup>4</sup>						
GFST8 (High Rigidity)		1.82	674	14.60x10 <sup>4</sup>	14.86x10 <sup>4</sup>						
EFSH8		1.97	731	14.30x10 <sup>4</sup>	14.71x10 <sup>4</sup>						
HFSH8		1.82	675	14.93x10 <sup>4</sup>	15.27x10 <sup>4</sup>						
EFSC8		1.98	735	14.41x10 <sup>4</sup>	15.02x10 <sup>4</sup>						
HFSC8											

## Fixed Length Extrusions (Effective Length 4000mm P.526)

⚠ Part numbers beginning with the character "K" indicate Fixed Length Extrusion.

Part Number	L mm	Sectional Area mm <sup>2</sup>	Cross Sectional Moment of Inertia mm <sup>4</sup>		Unit Price 1 ~ 9 pc(s)	Volume Discount Rate 10-20
KNEFST8	4545 4000 (Effective Length)	667	14.67x10 <sup>4</sup>	14.67x10 <sup>4</sup>		
KEFST8						
KHFST8		713	14.00x10 <sup>4</sup>	14.00x10 <sup>4</sup>		
KHFSTB8 (Black Anodize)						
KHFSLT8 (Light Type)		585	11.13x10 <sup>4</sup>	11.13x10 <sup>4</sup>		
KGFT8 (High Rigidity)						
KEFSH8		674	14.60x10 <sup>4</sup>	14.86x10 <sup>4</sup>		
KHFSH8						
KEFSC8		731	14.30x10 <sup>4</sup>	14.71x10 <sup>4</sup>		
KHFSB8						
KHFSL8	675	14.93x10 <sup>4</sup>	15.27x10 <sup>4</sup>			
KHFSB8						
KHFSF8	735	14.41x10 <sup>4</sup>	15.02x10 <sup>4</sup>			
KHFSF8						

Ordering Example  
Part Number - L  
HFST8-4545 - 800  
KHFSB8-4545 - 4000

Alterations are available for Configurable Length Extrusions. For details of alterations, see P.755.

## Configurable Length Extrusions

Part Number	L 0.5mm Increment	Mass kg/m	Sectional Area mm <sup>2</sup>	Cross Sectional Moment of Inertia mm <sup>4</sup>		Unit Price (Less than 300mm)			Unit Price/m (300mm or More)		
				l <sub>x</sub>	l <sub>y</sub>	1 ~ 9 pc(s)	10-49	50-160	1 ~ 9 pc(s)	10-49	50-160
NEFS8	4590 50-4000 Applicable to 6000mm depending on products. Refer to Information of Special Orders (P.103) and contact the person in charge of Special Orders at MISUMI OCT Center. ⚠ Some extrusions are not applicable.	3.75	1390	32.67x10 <sup>4</sup>	125.3x10 <sup>4</sup>						
EFS8											
EFSB8 (Black Anodize)		4.14	1534	32.29x10 <sup>4</sup>	124.7x10 <sup>4</sup>						
HFS8											
HFSB8 (Black Anodize)		2.98	1101	22.87x10 <sup>4</sup>	87.16x10 <sup>4</sup>						
CAF8 (Clear Coating)											
NFSL8		5.22	1935	42.99x10 <sup>4</sup>	163.4x10 <sup>4</sup>						
HFSL8 (Light Type)											
GFS8 (High Rigidity)		3.60	1335	32.14x10 <sup>4</sup>	117.9x10 <sup>4</sup>						
EFSF8											
HFSF8	3.80	1408	30.92x10 <sup>4</sup>	116.8x10 <sup>4</sup>							

## Fixed Length Extrusions (Effective Length 4000mm P.526)

⚠ Part numbers beginning with the character "K" indicate Fixed Length Extrusion.

Part Number	L mm	Sectional Area mm <sup>2</sup>	Cross Sectional Moment of Inertia mm <sup>4</sup>		Unit Price 1 ~ 9 pc(s)	Volume Discount Rate 10-20	
KNEFS8	4590 4000 (Effective Length)	1390	32.67x10 <sup>4</sup>	125.3x10 <sup>4</sup>			
KEFS8							
KEFSB8 (Black Anodize)		1534	32.29x10 <sup>4</sup>	124.7x10 <sup>4</sup>			
KHFS8							
KHFSB8 (Black Anodize)		1101	22.87x10 <sup>4</sup>	87.16x10 <sup>4</sup>			
KCAF8							
KNFSL8		5.22	1935	42.99x10 <sup>4</sup>	163.4x10 <sup>4</sup>		
KHFSL8 (Light Type)							
KGFS8 (High Rigidity)		3.60	1335	32.14x10 <sup>4</sup>	117.9x10 <sup>4</sup>		
KEFSF8							
KHFSF8	3.80	1408	30.92x10 <sup>4</sup>	116.8x10 <sup>4</sup>			
KHFSF8							

Ordering Example  
Part Number - L  
HFS8-4590 - 800  
KHFSB8-4590 - 4000

Alterations are available for Configurable Length Extrusions. For details of alterations, see P.755.