

Type	Angular cams M DH2F H 40±2HRC S Nitrided (1000HV~)	Guide rails		Slide cores			Slide stroke amount	Page
		Guide type M DH2F H 40±2HRC S Nitrided (1000HV~)	Slide core retracting mechanism	No processing M DH2F H 40±2HRC	Inlay part processed M SKD11 H 58~60HRC	Tapped M SKD11 H 58~60HRC		
Standard Type		Combined type	Yes	MSCNB 	MSCKB 	MSCMB 	3mm 6mm 10mm	P.634
		Separate type	No	MSCNG 	MSCKG 	MSCMG 	3mm 6mm 10mm	
Slim type		Combined type	Yes		MSCSB 	MSCSBM 	3mm 6mm 10mm	P.638 P.639 P.640
			No		MSCSG 	MSCSGM 	3mm	P.637

Characteristics

- Space saving**
 - Allows downsizing of the mold due to the special structure in which the angular cam and the locking block are combined.
- With slide core lock mechanism**
 - Ball plunger leads to stable operation of the slide core.
- Equipped with slide core retracting mechanism**
 - Is safe when using along the direction of the gravity due to the incorporation of the spring unit in the unit guide.
- Total cost reduction**
 - Simple structure and low-cost
 - The angular cam, slide core and guide rail comes in a set, which does not require oblique hole boring, resulting in process cost savings. (Please procure the core part via in-house production.)
 - Eliminates the complex calculation such as the slide stroke, etc.
- Variation**
 - 3 options are available: amount of slide stroke ST=3・6・10mm.
 - Categories of slide cores
 - No processing**: Free machining at core section is possible
 - Inlay processed**: Big core handling is possible
 - Tapped**: Machining on core is easy
 - 3 types are available.
 - Guide rail types: Either separate type (compact) or combined type (no need to adjust guide rail) is available.
- Easy maintenance**
 - Easy to adjust the core part by plate processing as shown in the right figure.

Example

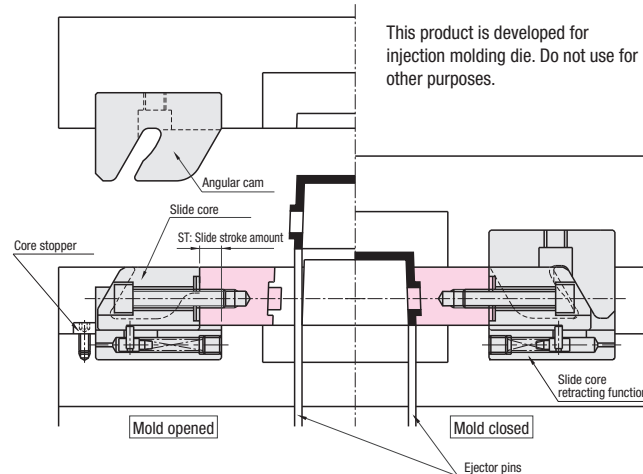

Slide core retracting function (Patent Acquisition)

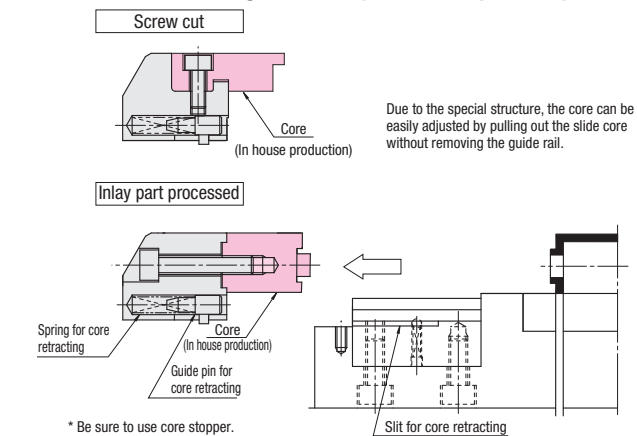

Mini Slide Core Units				
Slide core type			Guide type	
MSCN No processing RoHS 	MSCK Inlay part processed RoHS 	MSCM Tapped RoHS 	G Separate type RoHS 	B Combined type (with slide core retracting mechanism) RoHS
M DH2F H 40±2HRC	M SKD11 H 58~60HRC	M SKD11 H 58~60HRC	M DH2F H 40±2HRC S Nitrided (1000HV~)	M DH2F H 40±2HRC S Nitrided (1000HV~)

Guide type G separate type

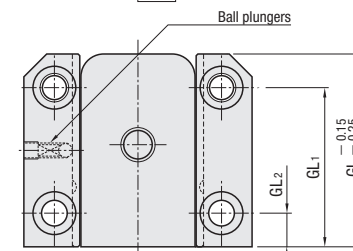

Guide type B combined type

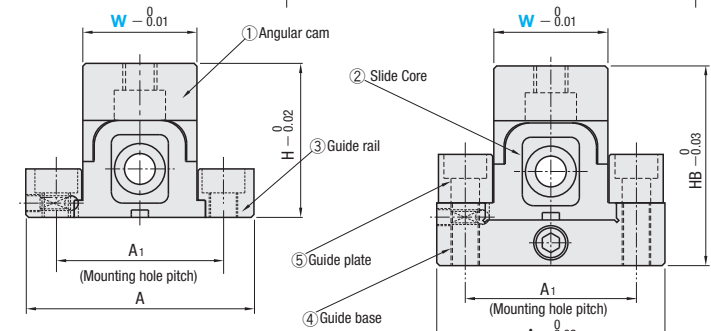
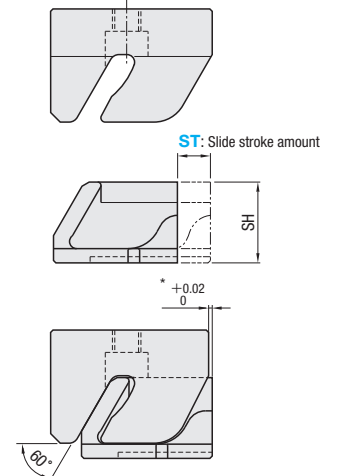
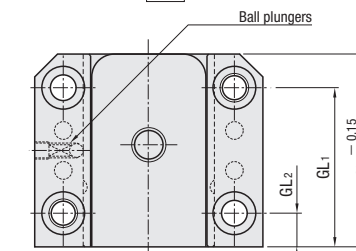

A	A1	GL	GL1	GL2	H	HB	SH	Part Number Type	Guide type	ST	W
28	22	20	15	5	18	24	10	MSCN (No processing)	G (Separate type)	3	12
40	30	34	28	6	27	35	17	MSCK (Inlay part processed)	B (Combined type)	6	20
42	32	50	40	10	40	50	25	MSCM (Tapped)		10	22
52	42									32	

Components (Single Items) Ⓜ Be sure to carry out installation adjustment before use.)

Component	Part Number	ST	W
① Angular cams	MSCC	3	12
		6	20
		10	22
		10L	32

Order	Part Number	ST	W
Type	Guide type		
MSCK	B	6	20
MSCC		6	20

Days to Ship **Quotation**

Price **Quotation**

*+0.02/0 is the precision of units. Note that the precision will change according to assembling.

Component details and page

① Angular cams	P.635
② Slide cores	
③ Guide rails	
④ Guide base	P.636
⑤ Guide plate	

Alterations	Part Number	ST	W	(SPC - BPW)
	MSCKB	10	32	SPC

Alterations	Code	Spec.	Code						
Strengthening of core retracting spring	SPC	Alterations on spring (WLH-SWC) and core retracting guide pins	Quotation						
		<table border="1"> <thead> <tr> <th>Spring</th> <th>WLH6-30</th> <th>SWC6-30</th> </tr> </thead> <tbody> <tr> <td>Load (N)</td> <td>min. 4.3</td> <td>7.7</td> </tr> <tr> <td></td> <td>max. 14.6</td> <td>26.3</td> </tr> </tbody> </table> <p>Ⓜ Only applicable to ST=10</p>		Spring	WLH6-30	SWC6-30	Load (N)	min. 4.3	7.7
Spring	WLH6-30	SWC6-30							
Load (N)	min. 4.3	7.7							
	max. 14.6	26.3							
Ball plungers are machined on both sides of the guide rail.	BPW								

Slide Cores
Loose Cores