

# MISUMI C-VALUE Screw-In Casters

- Medium Load - Wheel Material: Rubber

Comparing points of Similar Products | RoHS: Non-compliant. Running Test Criteria: Company internal standards based on GB (Run distance 1.5km). (Refer to P.2029 for details)

When ordering, select Part Number and Values from Selection Steps 1~3.

Ordering Example: Part Number (1 Type · 2 D) - 3 Wheel Material  
**C-CTMJ75 - R**

## Swivel Type

Type	Main Body		Wheel	Bearing	
	Material	Surface Treatment	Material (Color)	Swiveling Part	Wheel
C-CTMJ	SPCC	Zinc Plating	Rubber (Black)	Incorporated	Incorporated



CAD 2D 3D

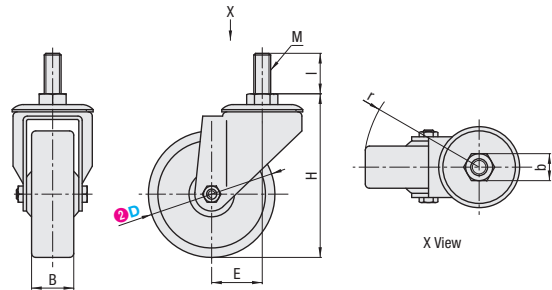

Part Number		Wheel Material	H	M	ℓ	B	E	b	r	Allowable Load (N)	Mass (g)
1 Type	2 D										
C-CTMJ	75	R (Rubber)	102	10	24	25	32.5	14	70	700	400
	100		136	12	25	30	40	18	90	1000	854
	125		160			37.5	47	24	107.5	1200	1270

## Swivel Type + Stopper

Type	Main Body		Wheel	Bearing	
	Material	Surface Treatment	Material (Color)	Swiveling Part	Wheel
C-CTMS	SPCC	Zinc Plating	Synthetic Rubber (Black)	Incorporated	Incorporated



CAD 2D 3D

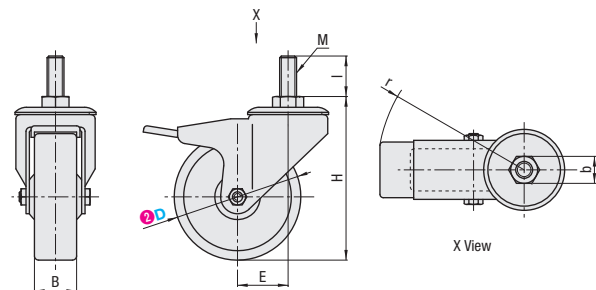

Part Number		Wheel Material	H	M	ℓ	B	E	b	r	Allowable Load (N)	Mass (g)
1 Type	2 D										
C-CTMS	75	R (Rubber)	102	10	24	25	32.5	14	93	700	475
	100		136	12	25	30	40	18	125	1000	1100
	125		160			37.5	47	24	127	1200	1450

# MISUMI C-VALUE Screw-In Casters

- Medium Load - Wheel Material: Polypropylene

Comparing points of Similar Products | RoHS: Non-compliant. Running Test Criteria: Company internal standards based on GB (Run distance 1.5km). (Refer to P.2029 for details)

When ordering, select Part Number and Values from Selection Steps 1~3.

Ordering Example: Part Number (1 Type · 2 D) - 3 Wheel Material  
**C-CTNJ80 - P**

## Swivel Type

Type	Main Body		Wheel	Bearing	
	Material	Surface Treatment	Material (Color)	Swiveling Part	Wheel
C-CTNJ	SPCC	Zinc Plating	Polypropylene (White)	Incorporated	None



CAD 2D 3D

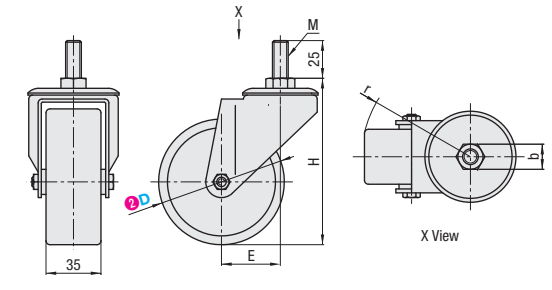

Part Number		Wheel Material	H	M	E	b	r	Allowable Load (N)	Mass (g)	
1 Type	2 D									
C-CTNJ	80	P (Polypropylene)	114	12	37.5	18	77.5	600	529	
	100		136		40			90	700	710
	125		160		47			24	109.5	900

## Swivel Type + Stopper

Type	Main Body		Wheel	Bearing	
	Material	Surface Treatment	Material (Color)	Swiveling Part	Wheel
C-CTNS	SPCC	Zinc Plating	Polypropylene (White)	Incorporated	None



CAD 2D 3D

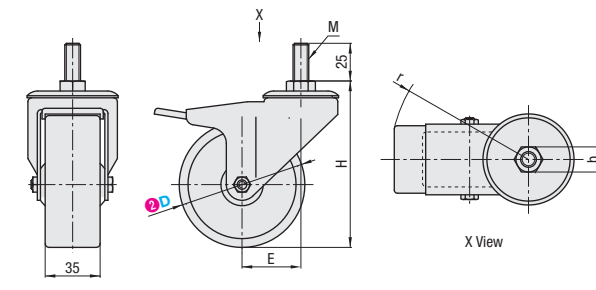

Part Number		Wheel Material	H	M	E	b	r	Allowable Load (N)	Mass (g)
1 Type	2 D								
C-CTNS	80	P (Polypropylene)	114	12	37.5	18	125	600	692
	100		136		40			700	820
	125		160		47			24	127