



HOT-WATER TUBES

TUBE CUTTERS / INSERT SLEEVES

Ⓜ Non JIS material definition is listed on P.1351 - 1352

M-NB RoHS  <small>PA12</small> Possible temperature of use -15~90°C	M-WE RoHS  <small>Polyolefine</small> Operating temperature limit : 0~99°C (Water) -30~99°C (Air)	M-SFT RoHS  <small>Fluorine resin</small> Possible temperature of use -65~180°C
---	--	--

Ext. dia. of tube	Int. dia. of tube	Min. Fix radius	Usable Pressure	Part Number		Full length L (meter)	Color C	U/Price 1~5			
				Type	No.			L5	L10	L20	L100
4	2.5	14	0~300 kPa 0~3 kgf/cm ²	M-NB	0425	5	B (Blue) W (Milky white)				
6	4	21			0640	10					
8	6	34			0860	20					
10	7.5	42			1075	100					
12	9	51			1290						
4	2.5	14	※ See the burst pressure table.	M-WE	0425	5	W (Milky white)	Quotation			
6	4	23			0640						
8	6	40			0860						
10	7.5	50			1075						
12	9	62			1290						
6	4	30	M-SFT	0640	20	C (Transparent)					
8	6	55		0860							
10	7.5	60		1075							
12	9	80	1290								

Ⓜ To be quoted on price & lead time above Max. Q'ty.

Order **Part Number** - **L** - **C**
M-NB0640 - **5** - **B**

Days to Ship **Quotation**

Example

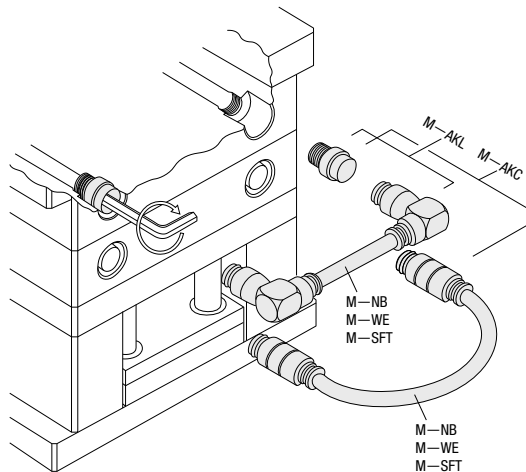

Burst pressure table of hot-water tube (M-SFT) MPa

Part Number	Temperature	0°C	20°C	40°C	60°C	80°C	100°C	120°C	140°C	160°C	180°C
M-SFT0640		6.6	5.8	5	3.9	3.1	2.9	2.7	2.4	2.2	2
M-SFT0860		4.7	4.1	3.6	2.8	2.2	2.1	1.9	1.7	1.6	1.4
M-SFT1075		4.7	4.1	3.6	2.8	2.2	2.1	1.9	1.7	1.6	1.4
M-SFT1290		4.7	4.1	3.6	2.8	2.2	2.1	1.9	1.7	1.6	1.4

Ⓜ Use it under the pressure of no more than 1/4 of the burst pressure as a rough guide.

Notes on handling

- Select an appropriate tube in accordance with cooling water temperature.
- The tube can be used for both cooling water and oil. (Water only for M-WE)
- Cut both ends of the tube squarely (at a right angle) to put it into a quick-fitting mold joint or bolting joint-otherwise the tube may come out unexpectedly or cause water leakage.
- Use the special insert sleeve (see Right page) together with these tubes to connect to a quick-fitting mold joint. Use without an insert sleeve may cause the tube to fall off unexpectedly or result in water leakage.
- The higher the temperature rises, the lower the burst pressure of hot-water tube (M-SFT) falls. Use the tube in high temperature after making sure of the burst pressure table above.
- When fitting the tube to bolting joints (P.1092) again, fit it after cutting the part fitted before. Usage without cutting could cause the tube to fall off unexpectedly or result in water leakage.

Tube Cutter



Part Number	Unit price	Slide Unit Price		
		1~9	10~19	20~29
M-TCN		Quotation		

Ⓜ To be quoted on price & lead time above Max. Q'ty.

Features of the Tube Cutters

- Using this tube cutter you can cut tubes much easier due to the tube guide R.
 Tube guide R ① For large tube cutting (10mm or more)
 ② For small tube cutting (8mm or less)
- This tube cutter is exclusively designed for use with M-WA/M-SFT tubes. Cutting any other tube products or wires may damage the tube cutter blades.
- Tube cutters are consumables that need to be replaced as required.

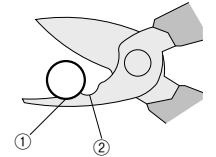

Insert sleeve (especially for quick-fitting joints for mold cooling)

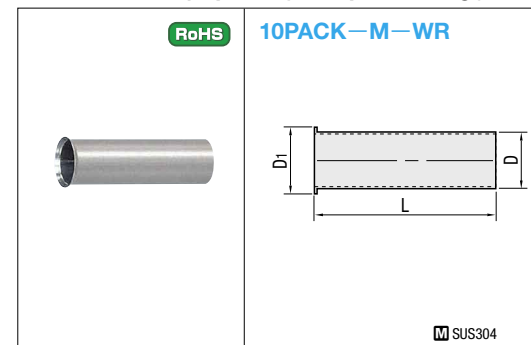

Applicable tube Ext. Dia. x Int. Dia.	D	D1	L	Part Number		U/Price 10 PACK
				Type	No.	
4x2.5	2.5	3	18	10PACK-M-WR	0425	Quotation
6x4	4	4.5	18.5		0640	
8x6	6	6.5	20		0860	
10x7.5	7.5	8	22		1075	
12x9	9	9.5	25		1290	

Features of the Insert Sleeve

Insert sleeves can prevent plastic tubes from coming loose or causing water leakage by holding them down when they become soft (due to hot water) or contract (due to water absorption by plastics in a prolonged usage).
 Ⓜ This is an insert sleeve especially for quick-fitting joints for mold cooling. Not applicable for bolting joints (P.1092).

Order **Part Number**
10PACK-M-WR0425

Days to Ship **Quotation**

Example

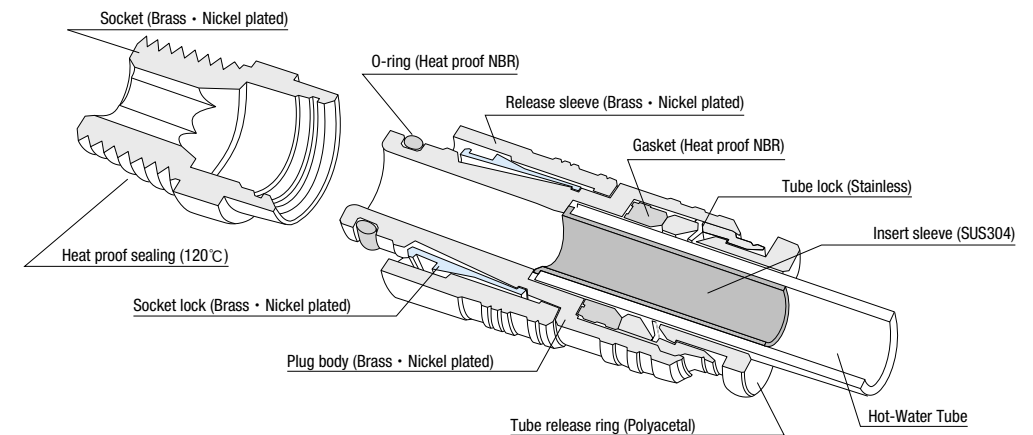

Cooling Components ②
 Joints · Hoses
 Cooling Inside of Mold