

SHORT BLOCK PUNCH BLANKS

RoHS

M L	Catalog No.		
	Tapped	Single flange	Double flanges
Equivalent to SKD11 60~63HRC	HMBS	HFBS	HWBS
Powdered high-speed steel 64~67HRC	PHMBS	PHFBS	PHWBS

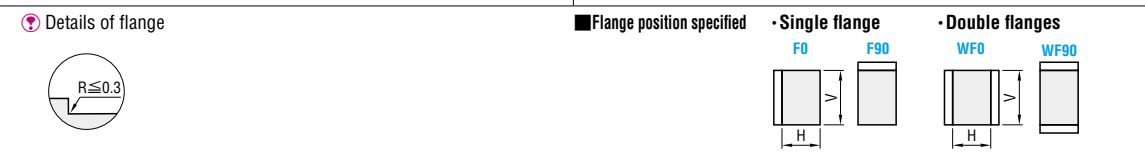
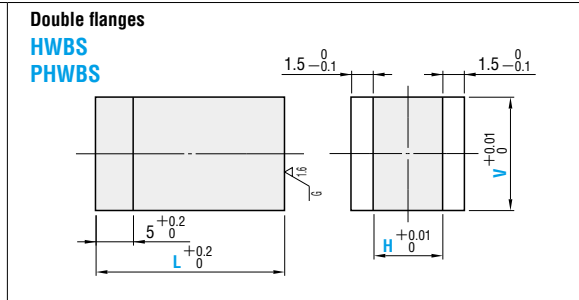
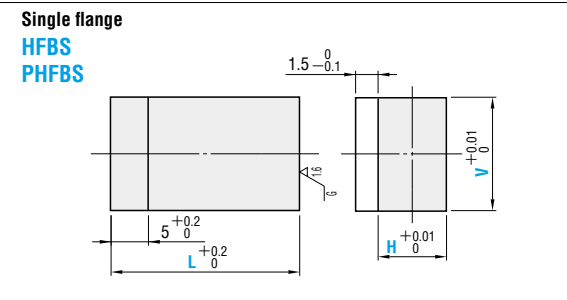
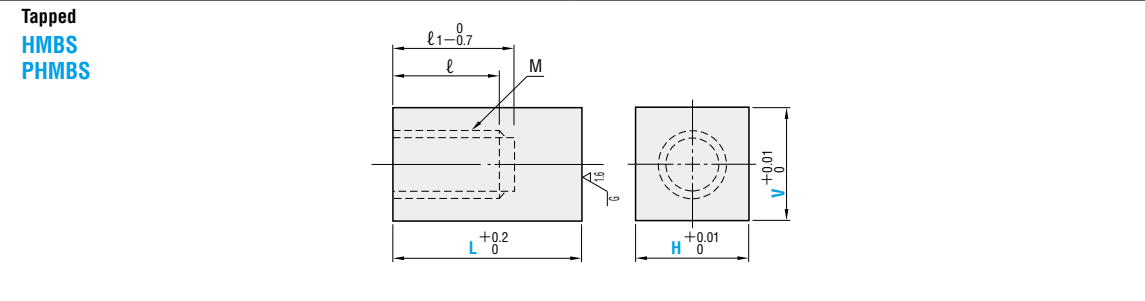

Catalog No.		H	V	6	8	10	13	16	20	L	M	ℓ	ℓ1
Tapped	HMBS	6	6	○	○	○	○	○	○	(13)	4	6	8.5
	PHMBS	8	8		○	○	○	○	○		5	7.5	10.0
Single flange	HFBS	10	10			○	○	○	○	(16)	6	9	12.5
	PHFBS	13	13				○	○	○		20		
Double flanges	HWBS	16	16					○	○	25	8	12	15.5
	PHWBS	20	20						○				

⚠ Tapped (HMBS · PHMBS)

- L (13) → L13 is a specification available for H6 · H8 only.
- L (16) → L16 is a specification available for H6 ~ H10 only.

Order

Catalog No. **HFBS** **08** **06** - **20** - **F90**

Days to Ship **Quotation**

- Features**
- These are short type block punch blanks which can be installed onto the stripper plate.
 - The tapped types feature tap lengths and pilot hole lengths that are shorter than conventional types.

Alterations

Catalog No. **PHFBS** **20** **10** - **LC15.5** - **F·WF** - **F0** - **TC2.5** (HC·TC·TKC, etc.)

Alteration	Code	Spec.	1Code																																								
Alterations to full length	LC	Full length change 0.1mm increments 13 < LC < 25 ⚠ For tapped types (HMBS·PHMBS), the LC ranges are shown below.																																									
Alterations to tap	MC	Tap diameter change	Quotation																																								
		<table border="1"> <thead> <tr> <th>H</th> <th>V</th> <th>6</th> <th>8</th> <th>10</th> <th>13</th> <th>16</th> <th>20</th> </tr> </thead> <tbody> <tr> <td>6</td> <td>6</td> <td></td> <td></td> <td></td> <td></td> <td>M4 → M3</td> <td></td> </tr> <tr> <td>8</td> <td>8</td> <td></td> <td></td> <td></td> <td></td> <td>M5 → M4</td> <td></td> </tr> <tr> <td>10</td> <td>10</td> <td></td> <td></td> <td></td> <td></td> <td>M6 → M5</td> <td></td> </tr> <tr> <td>13</td> <td>13</td> <td></td> <td></td> <td></td> <td></td> <td>M8 → M6</td> <td></td> </tr> </tbody> </table>		H	V	6	8	10	13	16	20	6	6					M4 → M3		8	8					M5 → M4		10	10					M6 → M5		13	13					M8 → M6	
H	V	6		8	10	13	16	20																																			
6	6					M4 → M3																																					
8	8					M5 → M4																																					
10	10					M6 → M5																																					
13	13					M8 → M6																																					
		⚠ For M3, the ℓ1 dimension is 7 ⁰ _{-0.7} .																																									
Alterations to flange	HC	Flange width change 0 ≤ HC < 1.5 0.1mm increments																																									
	TC	Flange thickness change 0.1mm increments (if combined with TKC, 0.01mm increments can be selected.) ⚠ Full length L is shortened by (5-TC). If combined with LC, full length is equal to LC.																																									
	TKC	Flange tolerance change T +0.2 / 0 ⇨ +0.02 / 0																																									
	TKM	Flange tolerance change T +0.2 / 0 ⇨ 0 / -0.02																																									

Price **Quotation**

Alteration	Code	Spec.	1Code
Alterations to shape	CC	Chamfering to four corners of shank The four corners of shank are chamfered to C0.5.	
	CCP	Chamfering to one corner of shank (for error prevention) One corner of shank is chamfered to C1.0. Can be used if distances a and b from tip corners to shank meet the following conditions. a + b ≥ 1.3	Quotation
	CCP0	CCP90	
		⚠ Can be used for tapped types only.	

BLOCK PUNCHES